

DC motor with permanent magnet

Properties:	Connection:	Connection to the power supply, battery, PWM controller or control amplifier, residual ripple of the operating voltage max. 5% Cable connection, optional plug-in connector
	Commutation:	Mechanical commutation using a 12-part commutator
	Magnetic system:	2-pole permanent ferrite magnet
	Service life:	5,000 h, S1 duty
	Insulation mat. class:	B, optional F
	System of protection:	IP 40, optional IP 65
	Special model:	Design for short-time operation with high performance, additional voltages and speeds upon request
	Options:	Special shafts, custom designed

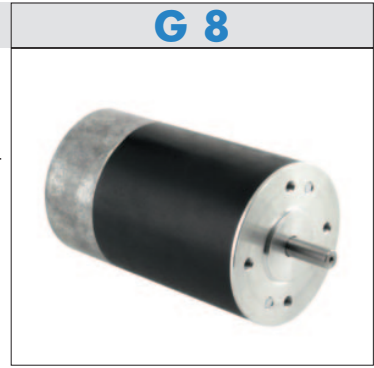

Type	Name	U	DC voltage	G 865	G 865 S
	Nominal voltages			24	24
Rate	Nominal power	P ₂	W	72.0	95
	Nominal speed	n _{nom}	rpm	3000	3000
	Nominal torque	T _{nom}	Ncm	23	30.2
	Nominal current	I _{nom}	A	3.9	5
	Starting torque	T _A	Ncm	130	160
	Idling speed	n _{idle}	rpm	3600	3700
	No-load current	I ₀	A	0.4	0.4
	Characteristics	Gradient speed torque curve	1 / k	mNm / rpm	0.58
Speed constant		c _n	rpm / V	129	129
Torque constant		c _T	Ncm / A	5.32	5.47
Nominal efficiency		η		0.72	0.75
Connection	Terminal resistance	R	Ohm	0.7	0.7
	Rated input power	P ₁	W	113	127
Dynamics	Weight	m	kg	2.1	2.2
	Moment of inertia	J	gcm ²	1325	1725
	Mech. time constant	τ _M	ms	24	29
Thermal	Adm. ambient temperature	T	°C	-20 to +40	-20 to +40
	Max. adm. rotor temperature	T _{max}	°C	+120	+120
Coupling	Shaft diameter	d	mm	8	8
	Max. axial force	F _a	N	20	20
	Max. radial force	F _r	N	220	220

Dimensions - Characteristics

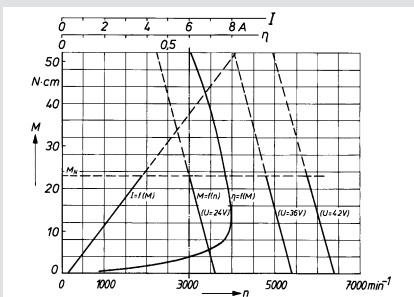

Type	L / mm
G 865	112
G 865 S	112

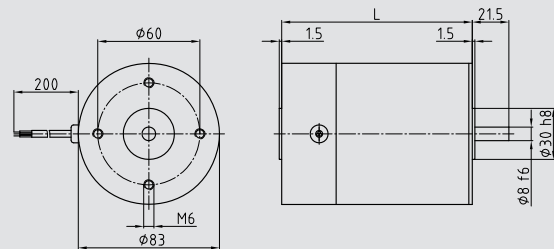

System technology

Recommended combinations other gears and extensions upon request	Worm gear	S 668	S 769	SC 401
	Spur gear	Z 8	M 7	M 10
	Planetary gear	PM 60	PM 80	
	Rotary encoder	RV 30	RI 30	
	Brake	B 77		
	Electronics	UCE 24		